

ZLKC  
 1/2 M12  $f=3.5\text{mm}$ 

5

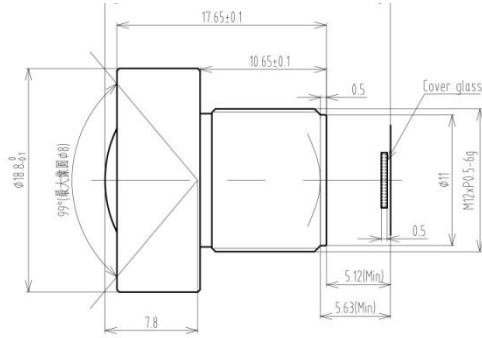

500 3.5mm M12 Mount		Working Distance	Optical Magnification	1/1.8" Field of View (mm)		
Model	<b>MTV035MP5C</b>	mm	-	H	V	
Image Size	1/2-inch	850	0.004X	1600	1200	
Focal length	<b>3.5mm</b>	800	0.0042X	1524	1143	
F No.	F2.8	750	0.0045X	1422	1007	
M.O.D(m)	0.1-Inf.	700	0.0048X	1333	1000	
Operation	Iris	Fix	650	0.0052X	1231	923.1
	Focus	Manual	600	0.0056X	1143	857.1
Angle of View (DxHxV)	1/2"	101°x87°x70.6°	550	0.0061X	1049	786.9
	1/3"	83°x72°x51°	500	0.0067X	955.2	716.4
Distortion	<0.5%	450	0.007X	914.3	685.7	
BFL	5.63mm	400	0.008X	800	600	
Mount	M12XP0.5	350	0.01X	640	480	
Object Dimension (mm)	361x270.4 (WD=300mm)	300	0.011X	581.8	436.4	
Resolution	5MP	250	0.013X	492.3	369.2	
Dimension	18.8x17.65mm	200	0.016X	400	300	
Weight	6.8g	150	0.022X	290.9	218.2	
Working Temperature	-20°C +60°C	100	0.032X	200	150	